

FLOOR PLANS:
1905, 2205, 2105, 2205, 2305

THE DEVELOPER RESERVES THE RIGHT TO MAKE CHANGES AND MODIFICATIONS TO THE INFORMATION CONTAINED HEREIN. FLOOR PLANS, LAYOUTS, AND FINISHES ARE SUBJECT TO CHANGE WITHOUT NOTICE. E & O.E.

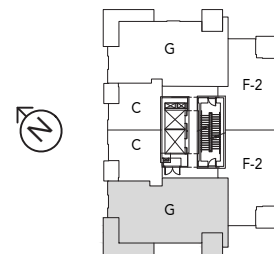

LEVELS 19-23