

**FLOOR PLANS:**  
 1902, 2202, 2102, 2202, 2302

THE DEVELOPER RESERVES THE RIGHT TO MAKE CHANGES AND MODIFICATIONS TO THE INFORMATION CONTAINED HEREIN. FLOOR PLANS, LAYOUTS, AND FINISHES ARE SUBJECT TO CHANGE WITHOUT NOTICE. E & O.E.

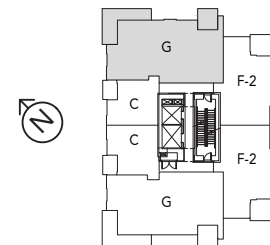

LEVELS 19-23