

FLOOR PLANS:

407, 507, 607, 707, 807, 907, 1007, 1107, 1207, 1307, 1407, 1507, 1607, 1707, 1807

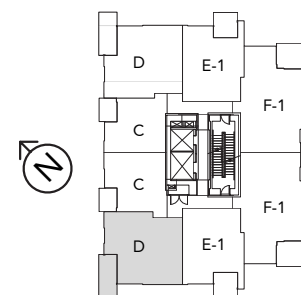

LEVEL 4-18

THE DEVELOPER RESERVES THE RIGHT TO MAKE CHANGES AND MODIFICATIONS TO THE INFORMATION CONTAINED HEREIN. FLOOR PLANS, LAYOUTS, AND FINISHES ARE SUBJECT TO CHANGE WITHOUT NOTICE. E & O.E.